

The Customer reserves all rights in respect of this document. This also applies to the granting of patents and registration of designs. This document may not be copied or made available to a third party without our express permission. It may not be subject to any unauthorised use by the recipient or by a third party.

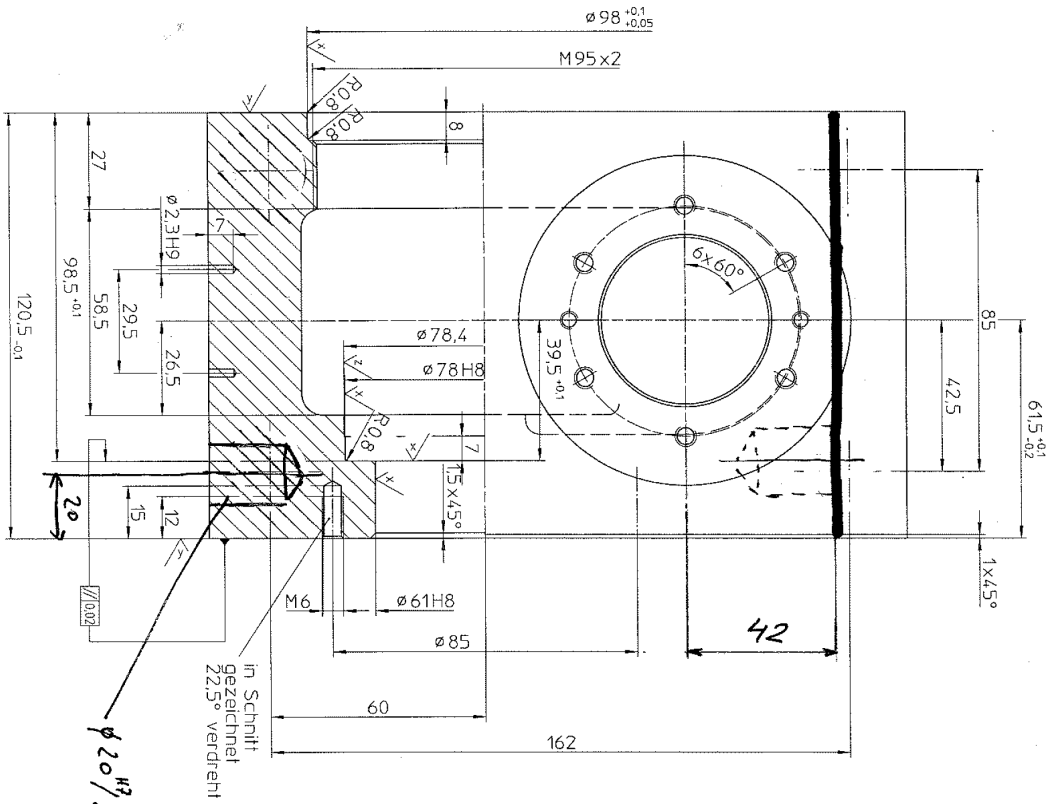

$\phi 20 \text{ H}^7 / 20 \text{ e}6 \text{ id}$

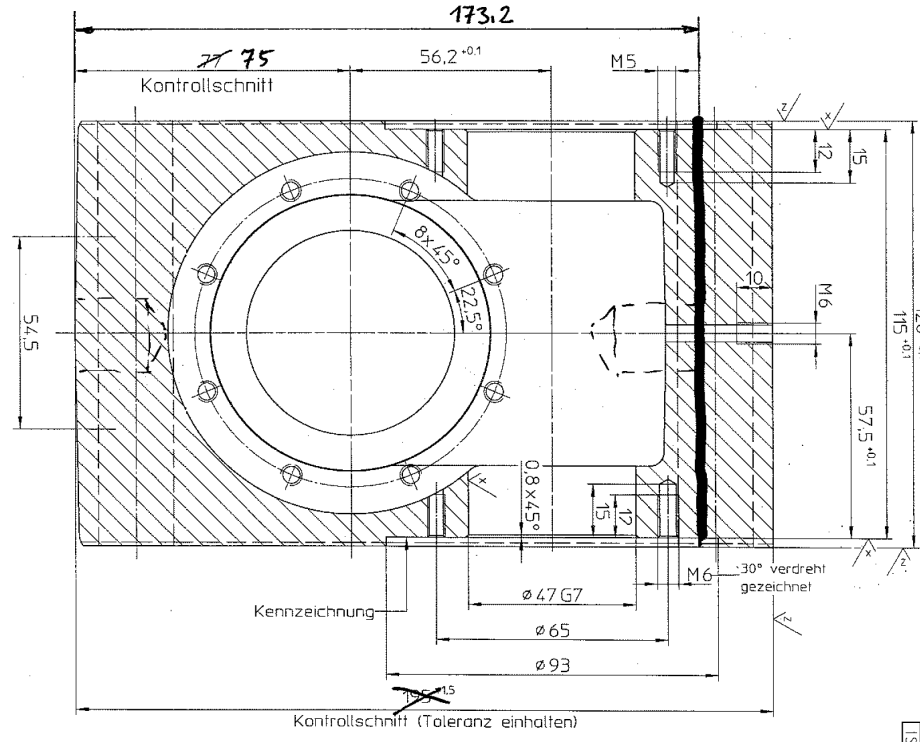

$\sqrt{0.2}$   $\sqrt{0.4}$   $\sqrt{0.8}$   $\sqrt{1.6}$   $\sqrt{3.2}$   $\sqrt{6.3}$   $\sqrt{12.5}$   $\sqrt{25}$   $\sqrt{50}$   $\sqrt{100}$

Nennmaß	Toleranz	ISO-Toleranzklasse	ISO-Toleranzabweichung
61 H8	0.016	8	+0.016
47 G7	0.004	7	-0.004
39 H8	0.009	8	+0.009
2.3 H9	0.005	9	+0.005

unben. Werkstückkanten  
noch DIN 6784 /  
All Edges chamfered

Allgemeintoleranzen	
DIN ISO 2768 - m	
Beitrag	21.06.02
Gepr.	REH
Proj.-Datum	29.05.16
Rev. N.	1

Bezeichnung/Title	
Gehäuse	
Zzeichnung N./Drawing N.	SGT50-1-09_3
Blatt N.	1
SG50-1-09	236710